

# Container / Trailer Storage Available at North America's Largest Inland Port



CenterPoint Intermodal Center | Lot 38: Cedar Creek Drive, Joliet, IL

CenterPoint Intermodal Center | Joliet, IL

LOT 38

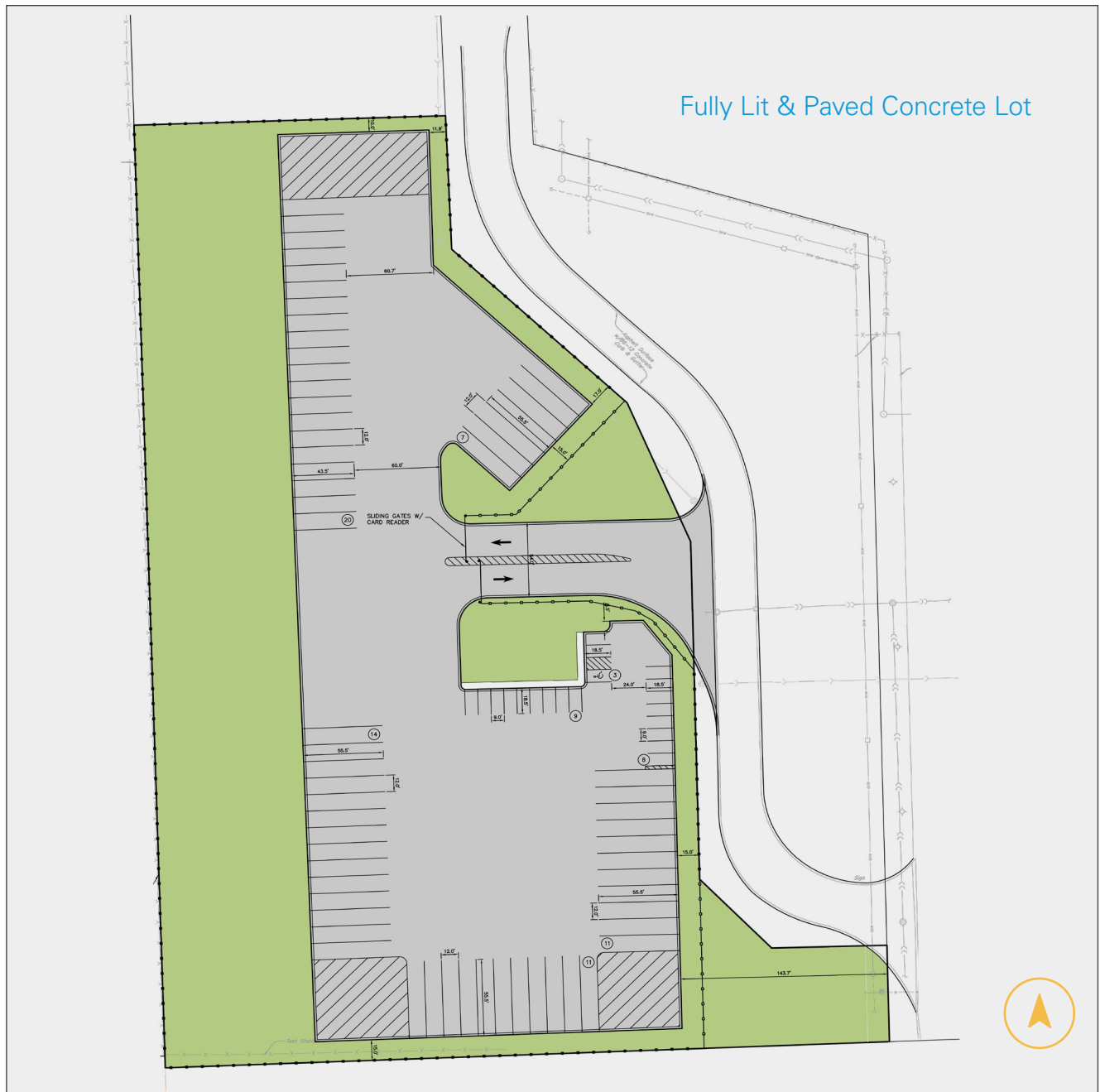

## Highlights

### Available

- ▶  $\pm 20$  Car parking
- ▶  $\pm 43$  Trailer stalls @ 55'
- ▶  $\pm 20$  Trailer stalls @ 43'
- ▶  $\pm 63$  Trailer stalls total



# Container / Trailer Storage Available at North America's Largest Inland Port



CenterPoint Intermodal Center | Lot 38: Cedar Creek Drive, Joliet, IL

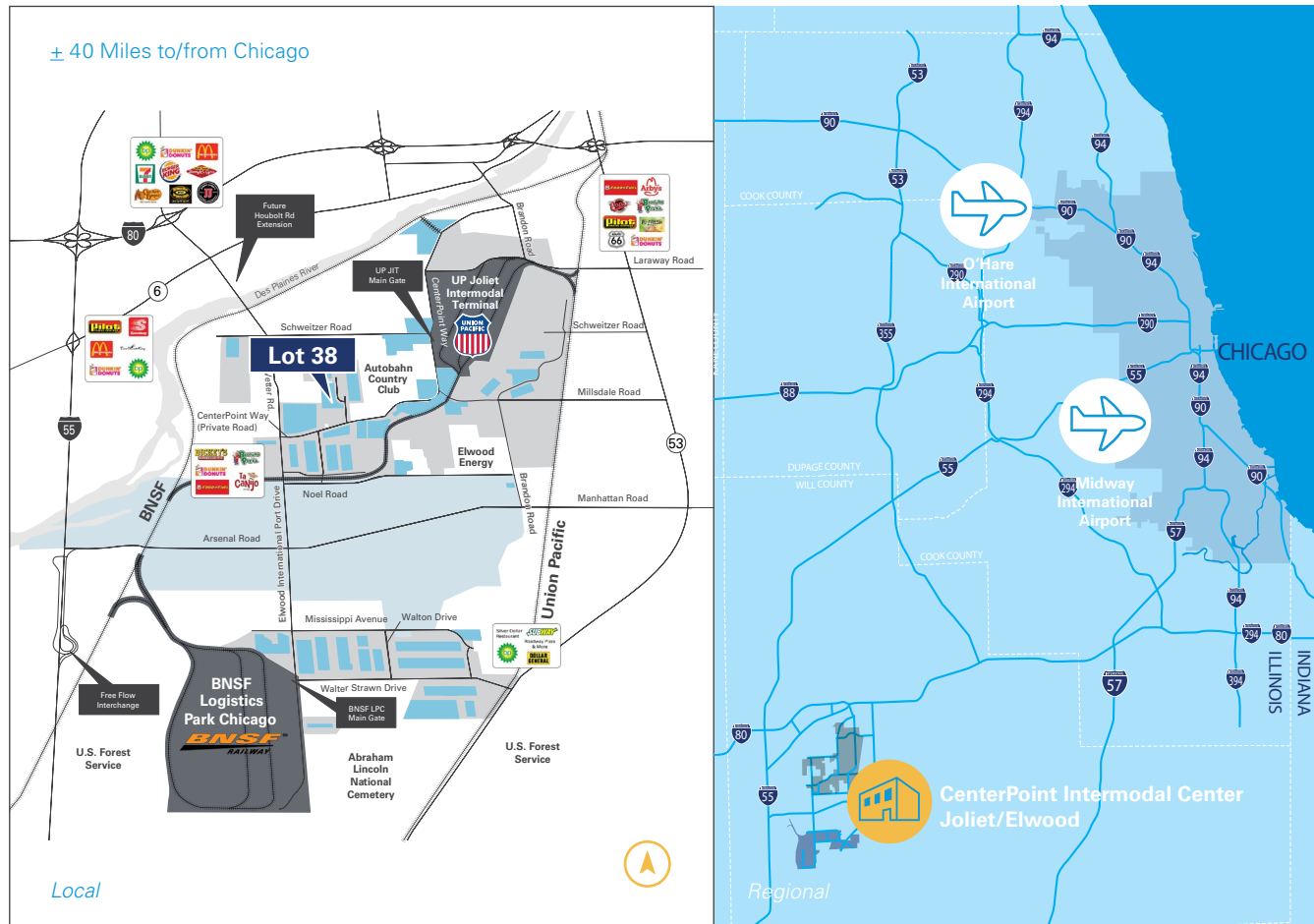

## Campus Advantages

- + Lowest drayage charges in the entire region
- + Direct access to the Union Pacific Joliet Intermodal Terminal (JIT) and BNSF Logistics Park Chicago (LPC)
- + North America's Largest Inland Port
- + Pre-designated Foreign Trade Zone & Enterprise Zone
- + Heavyweight capacity roads
- + On-site overflow container storage 24/7
- + Full interchange at I-55 and Arsenal Road
- + Minutes from intersection of I-55 and I-80
- + Low Will County real estate taxes
- + Flexible zoning for manufacturing, distribution or container operations
- + 40 ± miles to Chicago

## About CenterPoint

CenterPoint is a market leader in the development, redevelopment, acquisition and management of industrial real estate and transportation infrastructure to enhance business and supply chain efficiency. The company invests in major coastal and inland port logistics markets anchoring North America's principal freight lanes.

All information is subject to verification and no liability for errors or omissions is assumed.

Exclusive Marketing Agent



Dan Leahy, SIOR  
630.691.0604  
dleahy@hiffman.com

Adam Roth, CCIM, SIOR  
630.691.0607  
aroth@hiffman.com

Owned and Developed By



Brian McKiernan  
630.586.8113  
bmckiernan@centerpoint.com

[centerpoint.com](http://centerpoint.com)