

10 Acres

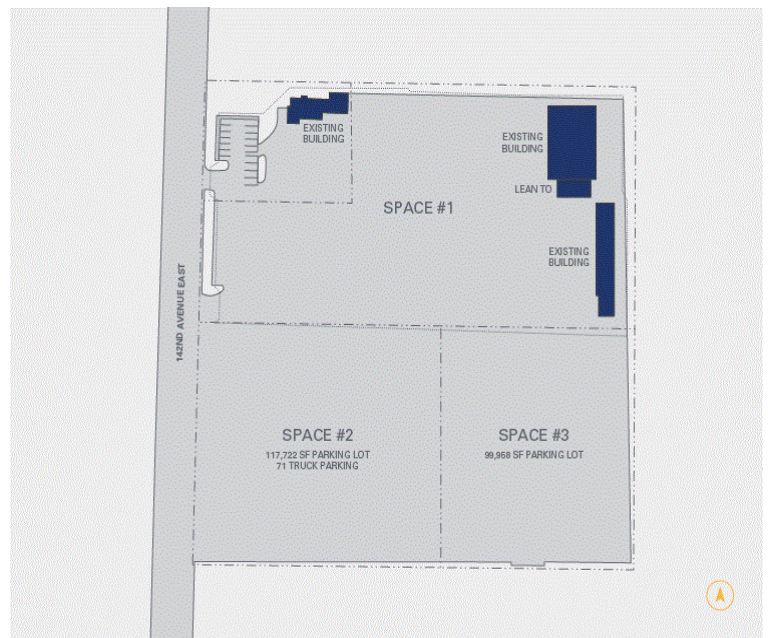

CenterPoint Properties

3407 – 3513 142nd Street, Sumner, WA

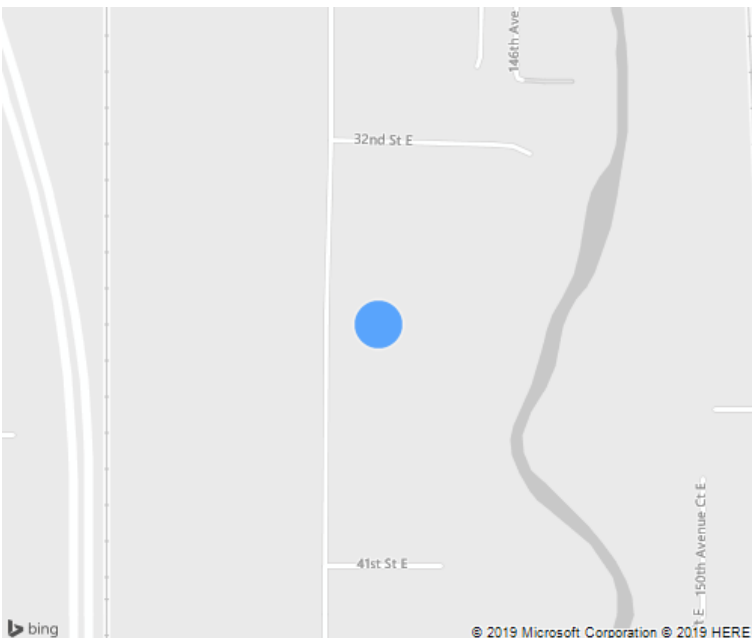

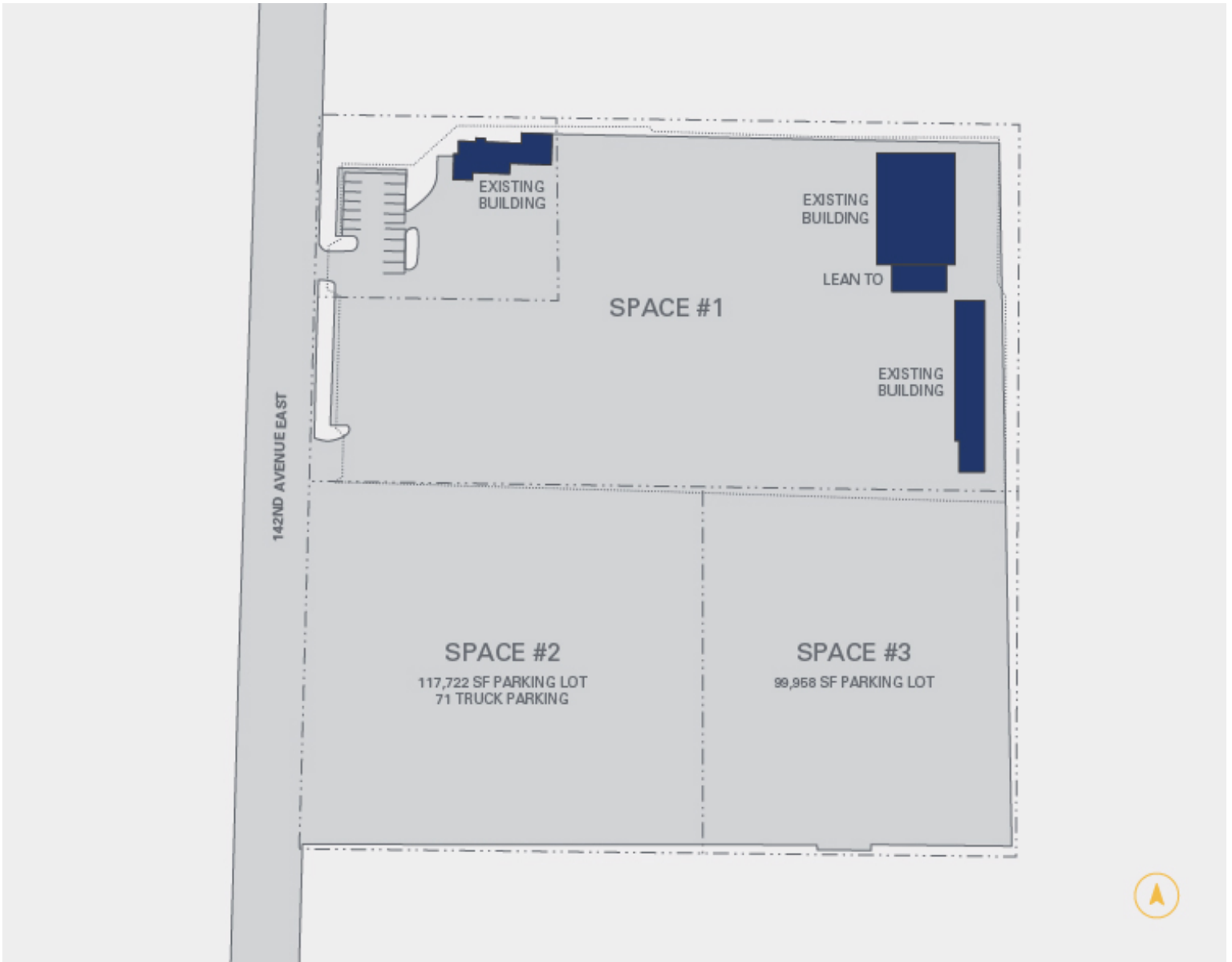

Property Description

Market: Seattle

Land: 10 Acres

Building: 13,642 SF

Office: 2,560 SF

Available: SF

Year Built: 1983

Rail Access: No

Renovated:

Car Parking: 17 spaces

Trailer Parking: 132 spaces

Clear Height: 25'

Exterior Docks: 0

Interior Docks: 0

Drive-In Doors: 4

Construction: Horizontal and vertical wood siding

Roof: Sloped fiberglass shingles

HVAC: AC, Electric Heat, No HVAC

Sprinkler: N/A

Power: N/A

Typical Bay Size: 75' x 50'

Available Units: 0